

Appendix M. Turning Templates

This page is intentionally left blank.

Intersection:	1 - Broadway and Vancouver/I-5													
Vehicle:	P		F-450		SU-30		BUS		Fire Truck ¹		WB-40		WB-67	
Turning Movement:	Existing	Proposed	Existing	Proposed	Existing	Proposed	Existing	Proposed	Existing	Proposed	Existing	Proposed	Existing	Proposed
LT - WB										A-CF ²				A-CF ²
RT - SB														A-LF ²

- Notes:** 1. T-1 Fire Truck used for modeling purposes unless otherwise noted in table.
2. Buffer reduction required. Typical buffer is 2ft and a buffer reduction is between 0-2ft
3. Smaller vehicle listed is using the curb (inside) lane unless otherwise noted.

LEGEND
Y = vehicle can negotiate the turning movement
N = vehicle cannot negotiate the turning movement
A = design movement can be accommodated by overswinging - see Design Vehicle Movements nomenclature.
NC = no change proposed from existing condition
NA = turning movement is not applicable for vehicle
- = turning movement not run because existing turning movement is not possible

Street Information:	
Posted Speed:	Broadway: 30 mph Williams: 25 mph
Street Classification:	Broadway: Civic Main Street Vancouver: Community Corridor
Transit Classification:	Broadway: Major City Traffic Street Vancouver: Major Transit Priority Street
Freight Route:	Broadway: Major Truck Street Vancouver: Local Service Truck Street
Emergency Response Class:	Broadway: Major Emergency Response Vancouver: Minor Emergency Repsponce
Bicycle Classification:	Broadway: Major City Bikeway Vancouver: Major City Bikeway

Source: <http://pdx.maps.arcgis.com/apps/webappviewer/index.html?id=d1d5e545ca6f436fb119932d710ff2fb>

CAD File: AutoTurn_I5_RoseQuarter.dgn
Level Naming Convention: <INTERSECTION#>_<VEHICLE-TYPE>_<LT or RT>_<DEPARTURE DIRECTION>_<EX or PR>

Color Code

Extg vehicle cannot make turn in proposed design
Extg design vehicle is only accomodated in proposed design
Extg vehicle and proposed vehicle are same with minor changes
No Change
Improved
Existing movement is prohibited by proposed design

Design Vehicle Movements:

LL = Lane to Lane - Stays in curb lane of exiting street. Turns into curb lane of entering street.
LC = Lane to Centerline - Stays in curb lane of exiting street. Uses half of entering street; does not cross centerline of entering street.
LF = Lane to Full Street - Stays in curb lane of exiting street. Uses full width of entering street.

CL = Centerline to Lane - Swings wide to use half width of exiting street before turning; does not cross centerline of exiting street. Turns into curb lane of entering street.
CC = Centerline to Centerline - Swings wide to use half width of exiting street before turning; does not cross centerline of exiting street. Uses half of entering street; does not cross centerline of entering street.
CF = Centerline to Full - Swings wide to use half width of exiting street before turning; does not cross centerline of exiting street. Uses full width of entering street.

FL = Full to Lane - Swings wide to use full width of exiting street before turning. Turns into curb lane of entering street.
FC = Full to Centerline - Swings wide to use full width of exiting street before turning. Uses half of entering street; does not cross centerline of entering street.
FF = Full to Full - Swings wide to use full width of exiting street before turning. Uses full width of entering street.

* All movements are assumed to not encroach into existing parking lanes. Any proposed parking removal must be noted.

EXAMPLE :
NB LT: Trimet 40ft bus LC, WB-67 FF
NB RT: SU-30 LL, WB-67 FF

Intersection:	2 - Broadway and Williams/I-5													
	Vehicle:		F-450		SU-30		BUS		Fire Truck ¹		WB-40		WB-67	
Turning Movement:	Existing	Proposed	Existing	Proposed	Existing	Proposed	Existing	Proposed	Existing	Proposed	Existing	Proposed	Existing	Proposed
RT - WB (I-5)														A-FF ²
RT - WB (Williams)										A-CC ²				
RT - WB (Side by Side) ³		Y-LL ²										Y-LL ²		
LT - WB														A-LF ²
LT - WB (Side by Side) ³												Y-LL ²		
LT - NB												A-LC ²		

- Notes: 1. T-1 Fire Truck used for modeling purposes unless otherwise noted in table.
2. Buffer reduction required. Typical buffer is 2ft and a buffer reduction is between 0-2ft
3. Smaller vehicle listed is using the curb (inside) lane unless otherwise noted.

LEGEND
Y = vehicle can negotiate the turning movement
N = vehicle cannot negotiate the turning movement
A = design movement can be accommodated by overswinging - see Design Vehicle Movements nomenclature.
NC = no change proposed from existing condition
NA = turning movement is not applicable for vehicle
- = turning movement not run because existing turning movement is not possible

Street Information:	
Posted Speed:	Broadway: 30 mph Williams: 25 mph
Street Classification:	Broadway: Civic Main Street Williams: Community Corridor
Transit Classification:	Broadway: Major Transit Priority Williams: Major Transit Priority
Freight Route:	Broadway: Major Truck Street Williams: Local Service Truck Street
Emergency Response Class:	Broadway: Major Emergency Response Williams: Major Emergency Response
Bicycle Classification:	Broadway: Major City Bikeway Williams: Major City Bikeway

Source: <http://pdx.maps.arcgis.com/apps/webappviewer/index.html?id=d1d5e545ca6f436fb119932d710ff2fb>

CAD File: AutoTurn_I5_RoseQuarter.dgn
Level Naming Convention: <INTERSECTION#>_<VEHICLE-TYPE>_<LT or RT>_<DEPARTURE DIRECTION>_<EX or PR>

Color Code

Extg vehicle cannot make turn in proposed design
Extg design vehicle is only accomodated in proposed design
Extg vehicle and proposed vehicle are same with minor changes
No Change
Improved
Existing movement is prohibited by proposed design

Design Vehicle Movements:

LL = Lane to Lane - Stays in curb lane of exiting street. Turns into curb lane of entering street.

LC = Lane to Centerline - Stays in curb lane of exiting street. Uses half of entering street; does not cross centerline of entering street.

LF = Lane to Full Street - Stays in curb lane of exiting street. Uses full width of entering street.

CL = Centerline to Lane - Swings wide to use half width of exiting street before turning; does not cross centerline of exiting street. Turns into curb lane of entering street.

CC = Centerline to Centerline - Swings wide to use half width of exiting street before turning; does not cross centerline of exiting street. Uses half of entering street; does not cross centerline of entering street.

CF = Centerline to Full - Swings wide to use half width of exiting street before turning; does not cross centerline of exiting street. Uses full width of entering street.

FL = Full to Lane - Swings wide to use full width of exiting street before turning. Turns into curb lane of entering street.

FC = Full to Centerline - Swings wide to use full width of exiting street before turning. Uses half of entering street; does not cross centerline of entering street.

FF = Full to Full - Swings wide to use full width of exiting street before turning. Uses full width of entering street.

* All movements are assumed to not encroach into existing parking lanes. Any proposed parking removal must be noted.

EXAMPLE :
NB LT: Trimet 40ft bus LC, WB-67 FF
NB RT: SU-30 LL, WB-67 FF

Intersection:	3 - Broadway and Victoria													
Vehicle:	P	F-450	SU-30	BUS	Fire Truck ¹	WB-40	WB-67							
Turning Movement:	Existing	Proposed	Existing	Proposed	Existing	Proposed	Existing	Proposed	Existing	Proposed	Existing	Proposed	Existing	Proposed
RT - WB				Y-LL ²						A-CF ²				
RT - SB				Y-LL										
LT - NB (Side by Side) ³													Y-LC ²	
LT - NB														A-CC ²

Notes: 1. T-1 Fire Truck used for modeling purposes unless otherwise noted in table.
2. Buffer reduction required. Typical buffer is 2ft and a buffer reduction is between 0-2ft
3. Smaller vehicle listed is using the curb (inside) lane unless otherwise noted.

LEGEND
Y = vehicle can negotiate the turning movement
N = vehicle cannot negotiate the turning movement
A = design movement can be accommodated by overswinging - see Design Vehicle Movements nomenclature.
NC = no change proposed from existing condition
NA = turning movement is not applicable for vehicle
- = turning movement not run because existing turning movement is not possible

Street Information:	
Posted Speed:	Broadway: 30 mph Victoria: 25 mph
Street Classification:	Broadway: Civic Main Street Victoria: Local Street
Transit Classification:	Broadway: Major Transit Priority Victoria: Local Service Transit Street
Freight Route:	Broadway: Major Truck Street Victoria: Local Service Truck Street
Emergency Response Class:	Broadway: Major Emergency Response Victoria: Minor Emergency Response
Bicycle Classification:	Broadway: Major City Bikeway Victoria: Local Service Bikeway

Source: <http://pdx.maps.arcgis.com/apps/webappviewer/index.html?id=d1d5e545ca6f436fb119932d710ff2fb>

CAD File: AutoTurn_I5_RoseQuarter.dgn
Level Naming Convention: <INTERSECTION#> <VEHICLE-TYPE> <LT or RT> <DEPARTURE DIRECTION> <EX or PR>

Color Code

Extg vehicle cannot make turn in proposed design
Extg design vehicle is only accomodated in proposed design
Extg vehicle and proposed vehicle are same with minor changes
No Change
Improved
Existing movement is prohibited by proposed design

Design Vehicle Movements:

LL = Lane to Lane - Stays in curb lane of exiting street. Turns into curb lane of entering street.
LC = Lane to Centerline - Stays in curb lane of exiting street. Uses half of entering street; does not cross centerline of entering street.
LF = Lane to Full Street - Stays in curb lane of exiting street. Uses full width of entering street.

CL = Centerline to Lane - Swings wide to use half width of exiting street before turning; does not cross centerline of exiting street. Turns into curb lane of entering street.
CC = Centerline to Centerline - Swings wide to use half width of exiting street before turning; does not cross centerline of exiting street. Uses half of entering street; does not cross centerline of entering street.
CF = Centerline to Full - Swings wide to use half width of exiting street before turning; does not cross centerline of exiting street. Uses full width of entering street.

FL = Full to Lane - Swings wide to use full width of exiting street before turning. Turns into curb lane of entering street.
FC = Full to Centerline - Swings wide to use full width of exiting street before turning. Uses half of entering street; does not cross centerline of entering street.
FF = Full to Full - Swings wide to use full width of exiting street before turning. Uses full width of entering street.

* All movements are assumed to not encroach into existing parking lanes. Any proposed parking removal must be noted.

EXAMPLE :
NB LT: Trimet 40ft bus LC, WB-67 FF
NB RT: SU-30 LL, WB-67 FF

Intersection:	4 - Weidler and Victoria													
Vehicle:	P		F-450		SU-30		BUS		Fire Truck ¹		WB-40		WB-67	
Turning Movement:	Existing	Proposed	Existing	Proposed	Existing	Proposed	Existing	Proposed	Existing	Proposed	Existing	Proposed	Existing	Proposed
LT - EB														A-LF ²
RT - NB (Side by Side) ³												Y-LL ²		A-LF ²

- Notes:** 1. T-1 Fire Truck used for modeling purposes unless otherwise noted in table.
2. Buffer reduction required. Typical buffer is 2ft and a buffer reduction is between 0-2ft
3. Smaller vehicle listed is using the curb (inside) lane unless otherwise noted.

LEGEND
Y = vehicle can negotiate the turning movement
N = vehicle cannot negotiate the turning movement
A = design movement can be accommodated by overswinging - see Design Vehicle Movements nomenclature.
NC = no change proposed from existing condition
NA = turning movement is not applicable for vehicle
- = turning movement not run because existing turning movement is not possible

Street Information:	
Posted Speed:	Weidler: 30 mph Victoria: 25 mph
Street Classification:	Weidler: Civic Corridor Victoria: Local Street
Transit Classification:	Weidler: Major Transit Priority Victoria: Local Service Transit Street
Freight Route:	Weidler: Major Truck Street Victoria: Local Service Truck Street
Emergency Response Class:	Weidler: Major Emergency Response Victoria: Minor Emergency Response
Bicycle Classification:	Weidler: Major City Bikeway Victoria: Local Service Bikeway

Source: <http://pdx.maps.arcgis.com/apps/webappviewer/index.html?id=d1d5e545ca6f436fb119932d710ff2fb>

CAD File: AutoTurn_I5_RoseQuarter.dgn
Level Naming Convention: <INTERSECTION#>_<VEHICLE-TYPE>_<LT or RT>_<DEPARTURE DIRECTION>_<EX or PR>

Color Code

Extg vehicle cannot make turn in proposed design
Extg design vehicle is only accomodated in proposed design
Extg vehicle and proposed vehicle are same with minor changes
No Change
Improved
Existing movement is prohibited by proposed design

Design Vehicle Movements:

LL = Lane to Lane - Stays in curb lane of exiting street. Turns into curb lane of entering street.
LC = Lane to Centerline - Stays in curb lane of exiting street. Uses half of entering street; does not cross centerline of entering street.
LF = Lane to Full Street - Stays in curb lane of exiting street. Uses full width of entering street.

CL = Centerline to Lane - Swings wide to use half width of exiting street before turning; does not cross centerline of exiting street. Turns into curb lane of entering street.
CC = Centerline to Centerline - Swings wide to use half width of exiting street before turning; does not cross centerline of exiting street. Uses half of entering street; does not cross centerline of entering street.
CF = Centerline to Full - Swings wide to use half width of exiting street before turning; does not cross centerline of exiting street. Uses full width of entering street.

FL = Full to Lane - Swings wide to use full width of exiting street before turning. Turns into curb lane of entering street.
FC = Full to Centerline - Swings wide to use full width of exiting street before turning. Uses half of entering street; does not cross centerline of entering street.
FF = Full to Full - Swings wide to use full width of exiting street before turning. Uses full width of entering street.

* All movements are assumed to not encroach into existing parking lanes. Any proposed parking removal must be noted.

EXAMPLE :
NB LT: Trimet 40ft bus LC, WB-67 FF
NB RT: SU-30 LL, WB-67 FF

Intersection:	5 - Weidler and Williams/I-5													
	Vehicle:		F-450		SU-30		BUS		Fire Truck ¹		WB-40		WB-67	
Turning Movement:	Existing	Proposed	Existing	Proposed	Existing	Proposed	Existing	Proposed	Existing	Proposed	Existing	Proposed	Existing	Proposed
LT - EB										A-CC ²				A-LF ²
RT - EB										A-CC ²				A-FF ²
RT - EB (Side by Side) ³		Y-LL ²										Y-LL ²		
LT - SB										A-CC ²				A-LF ²

- Notes:** 1. T-1 Fire Truck used for modeling purposes unless otherwise noted in table.
2. Buffer reduction required. Typical buffer is 2ft and a buffer reduction is between 0-2ft
3. Smaller vehicle listed is using the curb (inside) lane unless otherwise noted.

LEGEND
Y = vehicle can negotiate the turning movement
N = vehicle cannot negotiate the turning movement
A = design movement can be accommodated by overswinging - see Design Vehicle Movements nomenclature.
NC = no change proposed from existing condition
NA = turning movement is not applicable for vehicle
- = turning movement not run because existing turning movement is not possible

Street Information:	
Posted Speed:	Weidler: 30 mph Williams: 25 mph
Street Classification:	Weidler: Civic Corridor Williams: Community Corridor
Transit Classification:	Weidler: Major Transit Priority Williams: Major Transit Priority
Freight Route:	Weidler: Major Truck Street Williams: Local Service Truck Street
Emergency Response Class:	Weidler: Major Emergency Response Williams: Minor Emergency Response
Bicycle Classification:	Weidler: Major City Bikeway Williams: Major City Bikeway

Source: <http://pdx.maps.arcgis.com/apps/webappviewer/index.html?id=d1d5e545ca6f436fb119932d710ff2fb>

CAD File: AutoTurn_I5_RoseQuarter.dgn
Level Naming Convention: <INTERSECTION#>_<VEHICLE-TYPE>_<LT or RT>_<DEPARTURE DIRECTION>_<EX or PR>

Color Code

Extg vehicle cannot make turn in proposed design
Extg design vehicle is only accomodated in proposed design
Extg vehicle and proposed vehicle are same with minor changes
No Change
Improved
Existing movement is prohibited by proposed design

Design Vehicle Movements:

LL = Lane to Lane - Stays in curb lane of exiting street. Turns into curb lane of entering street.

LC = Lane to Centerline - Stays in curb lane of exiting street. Uses half of entering street; does not cross centerline of entering street.

LF = Lane to Full Street - Stays in curb lane of exiting street. Uses full width of entering street.

CL = Centerline to Lane - Swings wide to use half width of exiting street before turning; does not cross centerline of exiting street. Turns into curb lane of entering street.

CC = Centerline to Centerline - Swings wide to use half width of exiting street before turning; does not cross centerline of exiting street. Uses half of entering street; does not cross centerline of entering street.

CF = Centerline to Full - Swings wide to use half width of exiting street before turning; does not cross centerline of exiting street. Uses full width of entering street.

FL = Full to Lane - Swings wide to use full width of exiting street before turning. Turns into curb lane of entering street.

FC = Full to Centerline - Swings wide to use full width of exiting street before turning. Uses half of entering street; does not cross centerline of entering street.

FF = Full to Full - Swings wide to use full width of exiting street before turning. Uses full width of entering street.

* All movements are assumed to not encroach into existing parking lanes. Any proposed parking removal must be noted.

EXAMPLE :
NB LT: Trimet 40ft bus LC, WB-67 FF
NB RT: SU-30 LL, WB-67 FF

Intersection:	6 - Weidler and Vancouver														
	Vehicle:	P	F-450	SU-30	BUS	Fire Truck ¹	WB-40	WB-67							
Turning Movement:	Existing	Proposed	Existing	Proposed	Existing	Proposed	Existing	Proposed	Existing	Proposed	Existing	Proposed	Existing	Proposed	
RT - EB												A-CC ²		A-LC ²	
RT - NB (Side by Side) ³		Y-LL ²										Y-LL ²			
RT - NB								Y-LL ²							
LT - SB (Side by Side) ³		Y-LL ²		Y-LL ²											
LT - SB											A-CF ²				A-CF ²

- Notes:** 1. T-1 Fire Truck used for modeling purposes unless otherwise noted in table.
2. Buffer reduction required. Typical buffer is 2ft and a buffer reduction is between 0-2ft
3. Smaller vehicle listed is using the curb (inside) lane unless otherwise noted.

LEGEND
Y = vehicle can negotiate the turning movement
N = vehicle cannot negotiate the turning movement
A = design movement can be accommodated by overswinging - see Design Vehicle Movements nomenclature.
NC = no change proposed from existing condition
NA = turning movement is not applicable for vehicle
- = turning movement not run because existing turning movement is not possible

Street Information:	
Posted Speed:	Weidler: 30 mph Vancouver: 25 mph
Street Classification:	Weidler: Civic Corridor Vancouver: Community Corridor
Transit Classification:	Weidler: Major Transit Priority Vancouver: Major Transit Priority
Freight Route:	Weidler: Major Truck Street Vancouver: Local Service Truck Street
Emergency Response Class:	Weidler: Major Emergency Response Vancouver: Minor Emergency Response
Bicycle Classification:	Weidler: Major City Bikeway Vancouver: Major City Bikeway

Source: <http://pdx.maps.arcgis.com/apps/webappviewer/index.html?id=d1d5e545ca6f436fb119932d710ff2fb>

CAD File: AutoTurn_I5_RoseQuarter.dgn
Level Naming Convention: <INTERSECTION#>_<VEHICLE-TYPE>_<LT or RT>_<DEPARTURE DIRECTION>_<EX or PR>

Color Code

Extg vehicle cannot make turn in proposed design
Extg design vehicle is only accomodated in proposed design
Extg vehicle and proposed vehicle are same with minor changes
No Change
Improved
Existing movement is prohibited by proposed design

Design Vehicle Movements:

LL = Lane to Lane - Stays in curb lane of exiting street. Turns into curb lane of entering street.

LC = Lane to Centerline - Stays in curb lane of exiting street. Uses half of entering street; does not cross centerline of entering street.

LF = Lane to Full Street - Stays in curb lane of exiting street. Uses full width of entering street.

CL = Centerline to Lane - Swings wide to use half width of exiting street before turning; does not cross centerline of exiting street. Turns into curb lane of entering street.

CC = Centerline to Centerline - Swings wide to use half width of exiting street before turning; does not cross centerline of exiting street. Uses half of entering street; does not cross centerline of entering street.

CF = Centerline to Full - Swings wide to use half width of exiting street before turning; does not cross centerline of exiting street. Uses full width of entering street.

FL = Full to Lane - Swings wide to use full width of exiting street before turning. Turns into curb lane of entering street.

FC = Full to Centerline - Swings wide to use full width of exiting street before turning. Uses half of entering street; does not cross centerline of entering street.

FF = Full to Full - Swings wide to use full width of exiting street before turning. Uses full width of entering street.

* All movements are assumed to not encroach into existing parking lanes. Any proposed parking removal must be noted.

EXAMPLE :

NB LT: Trimet 40ft bus LC, WB-67 FF

NB RT: SU-30 LL, WB-67 FF

Intersection:	7 - Williams & Hancock													
	Vehicle:		F-450		SU-30		BUS		Fire Truck ¹		WB-40		WB-67	
Turning Movement:	Existing	Proposed	Existing	Proposed	Existing	Proposed	Existing	Proposed	Existing	Proposed	Existing	Proposed	Existing	Proposed
LT - NB										A-CF ²				
RT - NB										A-CF ²				
LT - EB										A-CF ²		A-LC ²		
RT - WB										A-CF ²				

- Notes:** 1. T-1 Fire Truck used for modeling purposes unless otherwise noted in table.
2. Buffer reduction required. Typical buffer is 2ft and a buffer reduction is between 0-2ft
3. Smaller vehicle listed is using the curb (inside) lane unless otherwise noted.

LEGEND
Y = vehicle can negotiate the turning movement
N = vehicle cannot negotiate the turning movement
A = design movement can be accommodated by overswinging - see Design Vehicle Movements nomenclature.
NC = no change proposed from existing condition
NA = turning movement is not applicable for vehicle
- = turning movement not run because existing turning movement is not possible

Street Information:	
Posted Speed:	Williams: 25 mph Hancock: 20 mph
Street Classification:	Williams: Community Corridor Hancock: Local Street
Transit Classification:	Williams: Major Transit Priority Hancock: Local Service Transit Street
Freight Route:	Williams: Local Service Truck Street Hancock: Local Service Truck Street
Emergency Response Class:	Williams: Minor Emergency Response Hancock: Minor Emergency Response
Bicycle Classification:	Williams: Major City Bikeway Hancock: Local Service Bikeway

Source: <http://pdx.maps.arcgis.com/apps/webappviewer/index.html?id=d1d5e545ca6f436fb119932d710ff2fb>

CAD File: AutoTurn_I5_RoseQuarter.dgn
Level Naming Convention: <INTERSECTION#>_<VEHICLE-TYPE>_<LT or RT>_<DEPARTURE DIRECTION>_<EX or PR>

Color Code

Extg vehicle cannot make turn in proposed design
Extg design vehicle is only accomodated in proposed design
Extg vehicle and proposed vehicle are same with minor changes
No Change
Improved
Existing movement is prohibited by proposed design

Design Vehicle Movements:

- LL = Lane to Lane** - Stays in curb lane of exiting street. Turns into curb lane of entering street.
 - LC = Lane to Centerline** - Stays in curb lane of exiting street. Uses half of entering street; does not cross centerline of entering street.
 - LF = Lane to Full Street** - Stays in curb lane of exiting street. Uses full width of entering street.
 - CL = Centerline to Lane** - Swings wide to use half width of exiting street before turning; does not cross centerline of exiting street. Turns into curb lane of entering street.
 - CC = Centerline to Centerline** - Swings wide to use half width of exiting street before turning; does not cross centerline of exiting street. Uses half of entering street; does not cross centerline of entering street.
 - CF = Centerline to Full** - Swings wide to use half width of exiting street before turning; does not cross centerline of exiting street. Uses full width of entering street.
 - FL = Full to Lane** - Swings wide to use full width of exiting street before turning. Turns into curb lane of entering street.
 - FC = Full to Centerline** - Swings wide to use full width of exiting street before turning. Uses half of entering street; does not cross centerline of entering street.
 - FF = Full to Full** - Swings wide to use full width of exiting street before turning. Uses full width of entering street.
- * All movements are assumed to not encroach into existing parking lanes. Any proposed parking removal must be noted.
- EXAMPLE :**
NB LT: Trimet 40ft bus LC, WB-67 FF
NB RT: SU-30 LL, WB-67 FF

Intersection:	8 - Ramsay & Wheeler/Williams													
	Vehicle:		F-450		SU-30		BUS		Fire Truck ¹		WB-40		WB-67	
Turning Movement:	Existing	Proposed	Existing	Proposed	Existing	Proposed	Existing	Proposed	Existing	Proposed	Existing	Proposed	Existing	Proposed
LT - EB										A-LC ²				
RT - EB										A-CC ²				
LT - EB (Side by Side) ³				Y-LL ²										
LT - SB										A-LF ²				
RT - WB												A-FC ²		

- Notes:** 1. T-1 Fire Truck used for modeling purposes unless otherwise noted in table.
2. Buffer reduction required. Typical buffer is 2ft and a buffer reduction is between 0-2ft
3. Smaller vehicle listed is using the curb (inside) lane unless otherwise noted.

LEGEND
Y = vehicle can negotiate the turning movement
N = vehicle cannot negotiate the turning movement
A = design movement can be accommodated by overswinging - see Design Vehicle Movements nomenclature.
NC = no change proposed from existing condition
NA = turning movement is not applicable for vehicle
- = turning movement not run because existing turning movement is not possible

Street Information:	
Posted Speed:	Wheeler: 25 mph Ramsay: 20 mph
Street Classification:	Wheeler: Local Street Ramsay: Local Street
Transit Classification:	Wheeler: Transit Access Street Ramsay: Local Service Transit Street
Freight Route:	Wheeler: Local Service Truck Street Ramsay: Local Service Truck Street
Emergency Response Class:	Wheeler: Major Emergency Response Ramsay: Minor Emergency Response
Bicycle Classification:	Wheeler: City Bikeway Ramsay: Local Service Bikeway

Source: <http://pdx.maps.arcgis.com/apps/webappviewer/index.html?id=d1d5e545ca6f436fb119932d710ff2fb>
<http://gis-pdx.opendata.arcgis.com>

CAD File: AutoTurn_I5_RoseQuarter.dgn
Level Naming Convention: <INTERSECTION#>_<VEHICLE-TYPE>_<LT or RT>_<DEPARTURE DIRECTION>_<EX or PR>

Color Code

Extg vehicle cannot make turn in proposed design
Extg design vehicle is only accomodated in proposed design
Extg vehicle and proposed vehicle are same with minor changes
No Change
Improved
Existing movement is prohibited by proposed design

Design Vehicle Movements:

LL = Lane to Lane - Stays in curb lane of exiting street. Turns into curb lane of entering street.

LC = Lane to Centerline - Stays in curb lane of exiting street. Uses half of entering street; does not cross centerline of entering street.

LF = Lane to Full Street – Stays in curb lane of exiting street. Uses full width of entering street.

CL = Centerline to Lane - Swings wide to use half width of exiting street before turning; does not cross centerline of exiting street. Turns into curb lane of entering street.

CC = Centerline to Centerline - Swings wide to use half width of exiting street before turning; does not cross centerline of exiting street. Uses half of entering street; does not cross centerline of entering street.

CF = Centerline to Full - Swings wide to use half width of exiting street before turning; does not cross centerline of exiting street. Uses full width of entering street.

FL = Full to Lane - Swings wide to use full width of exiting street before turning. Turns into curb lane of entering street.

FC = Full to Centerline - Swings wide to use full width of exiting street before turning. Uses half of entering street; does not cross centerline of entering street.

FF = Full to Full - Swings wide to use full width of exiting street before turning. Uses full width of entering street.

* All movements are assumed to not encroach into existing parking lanes. Any proposed parking removal must be noted.

EXAMPLE :

NB LT: Trimet 40ft bus LC, WB-67 FF

NB RT: SU-30 LL, WB-67 FF

**I-5: ROSE QUARTER
IMPROVEMENT PROJECT**

**AUTO TURN EXHIBITS
(LOCAL STREETS)**

INTERSECTION 1

20% DESIGN PACKAGE

Last updated: December 4, 2020

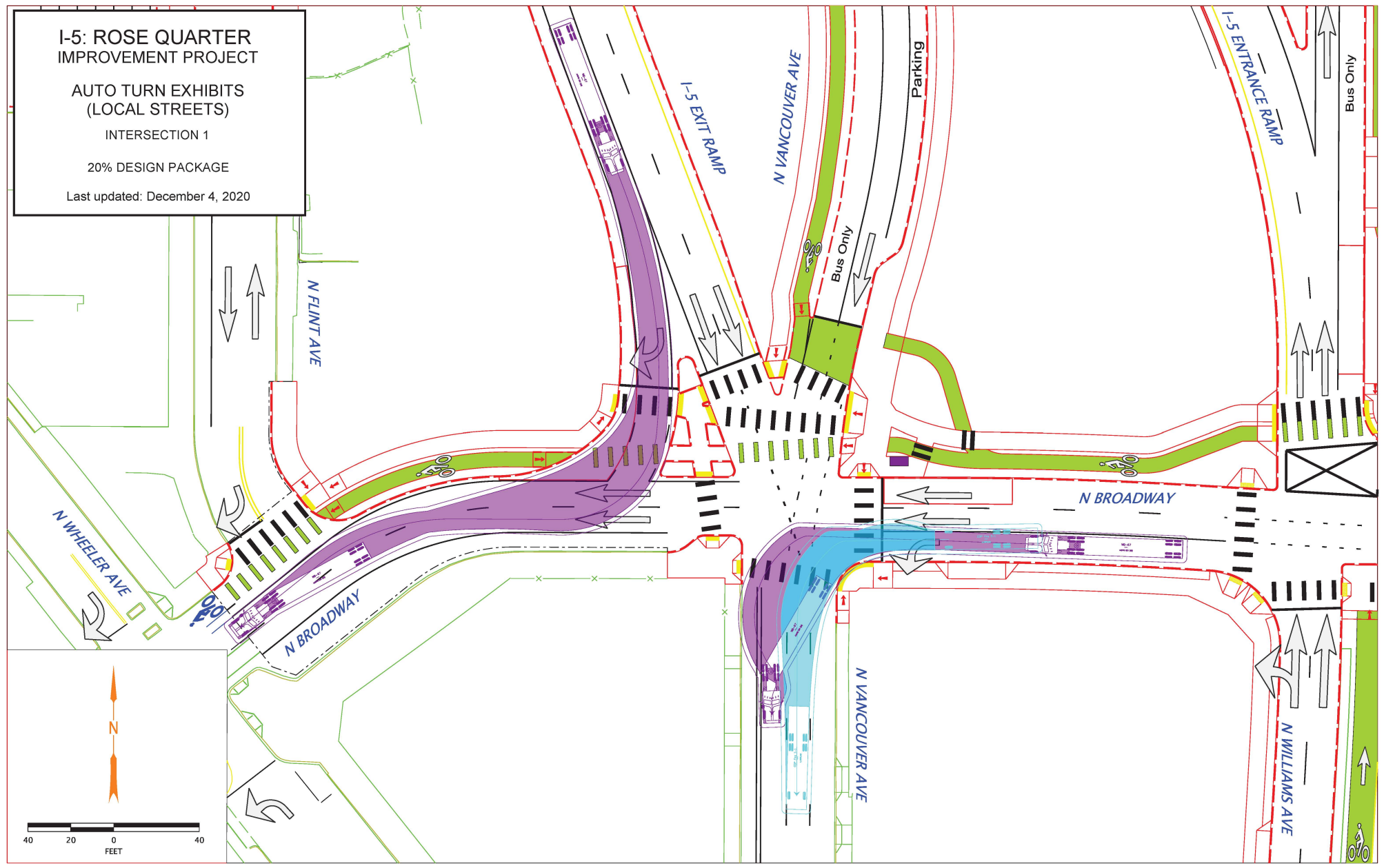

I-5: ROSE QUARTER
IMPROVEMENT PROJECT

AUTO TURN EXHIBITS
(LOCAL STREETS)

INTERSECTION 2 (1 OF 2)

20% DESIGN PACKAGE

Last updated: December 4, 2020

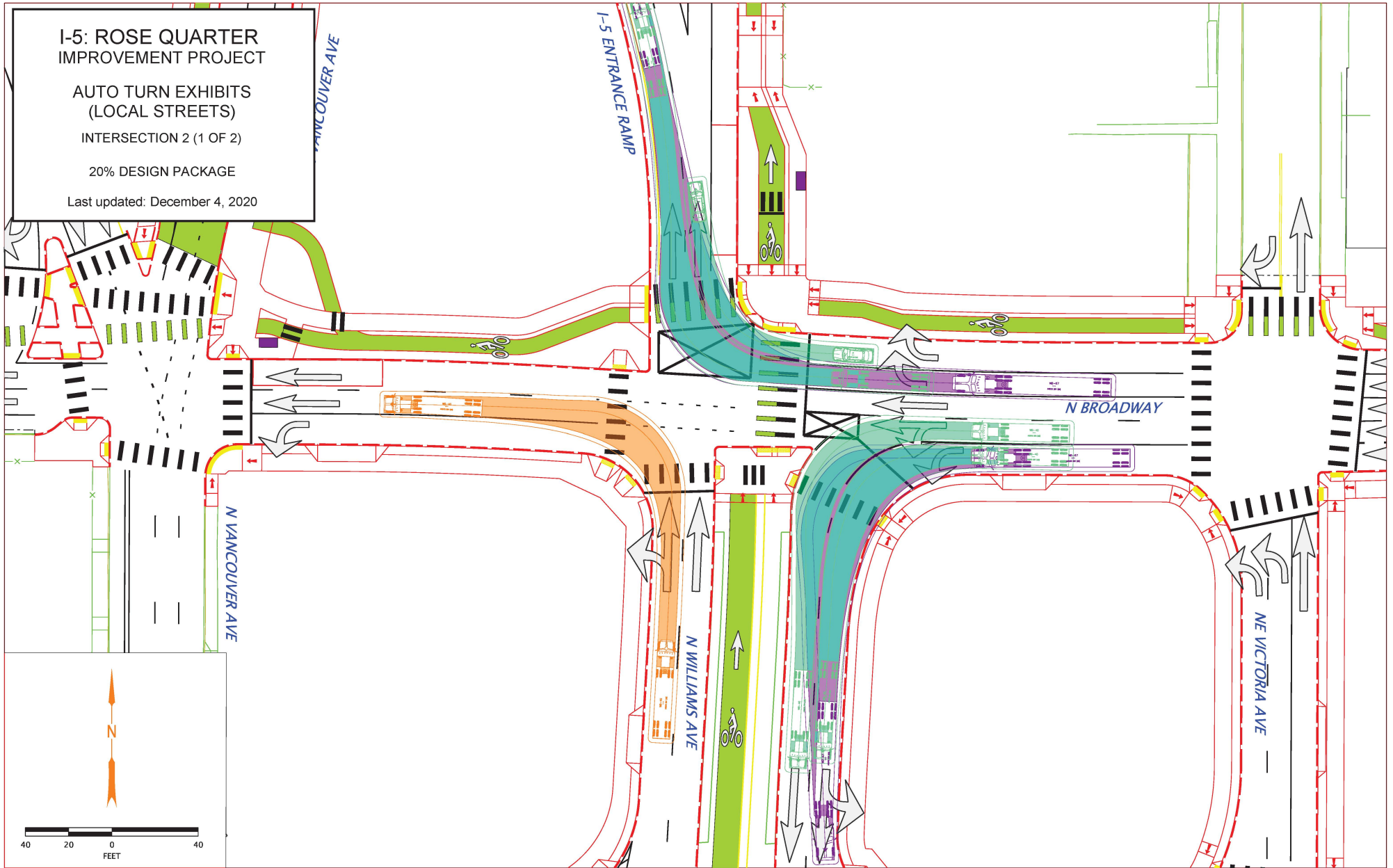

**I-5: ROSE QUARTER
IMPROVEMENT PROJECT**

**AUTO TURN EXHIBITS
(LOCAL STREETS)**

INTERSECTION 2 (2 OF 2)

20% DESIGN PACKAGE

Last updated: December 4, 2020

W VANCOUVER AVE

I-5 ENTRANCE RAMP

N BROADWAY

N VANCOUVER AVE

N WILLIAMS AVE

NE VICTORIA AVE

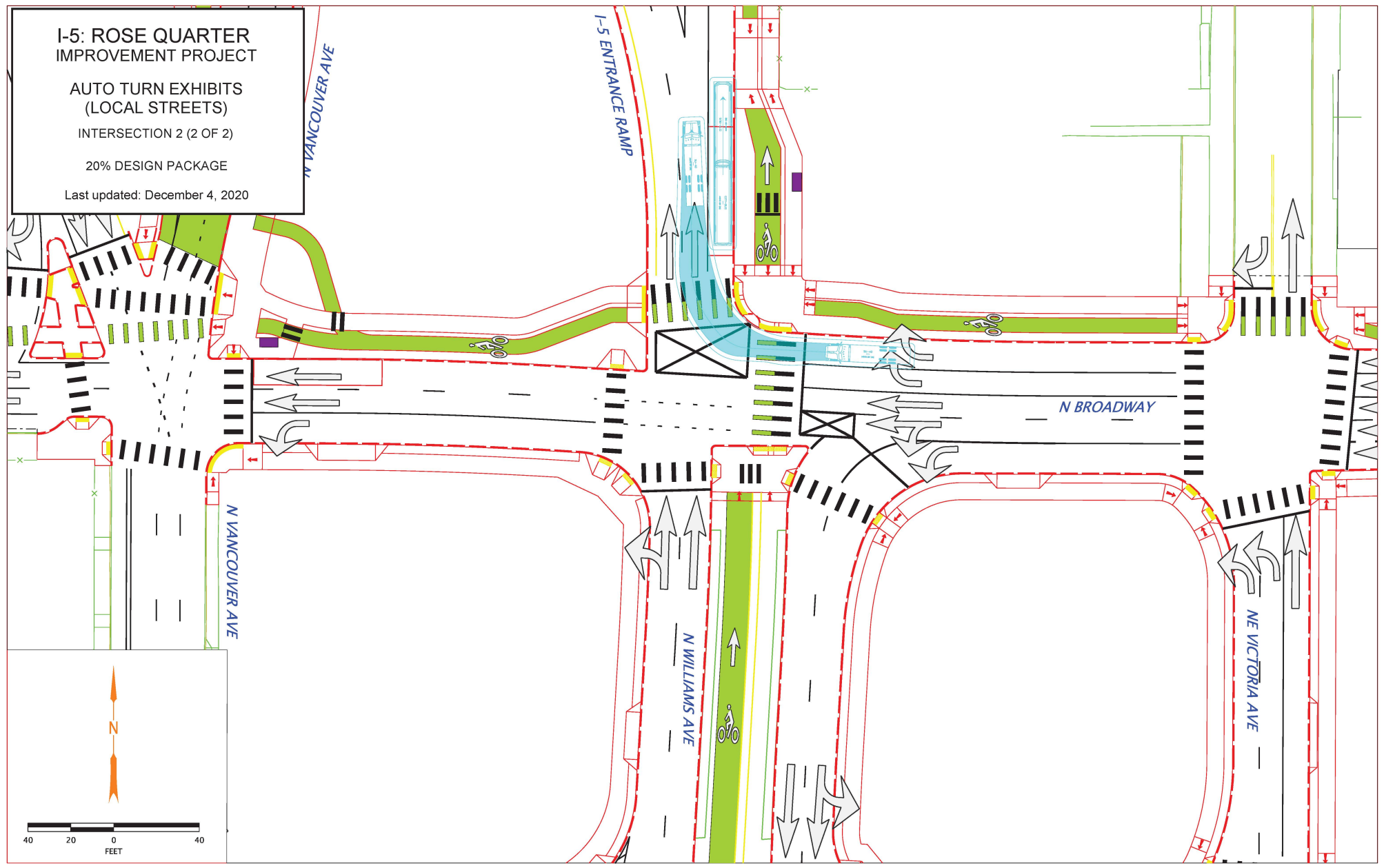
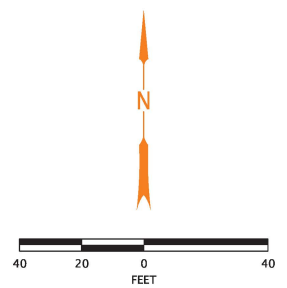

I-5: ROSE QUARTER
IMPROVEMENT PROJECT

AUTO TURN EXHIBITS
(LOCAL STREETS)

INTERSECTION 3

20% DESIGN PACKAGE

Last updated: December 4, 2020

N WILLIAMS AVE

NE VICTORIA AVE

NE 1st AVE

NE BROADWAY

N WILLIAMS AVE

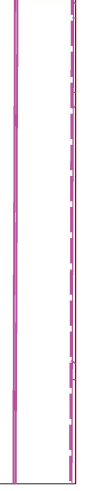
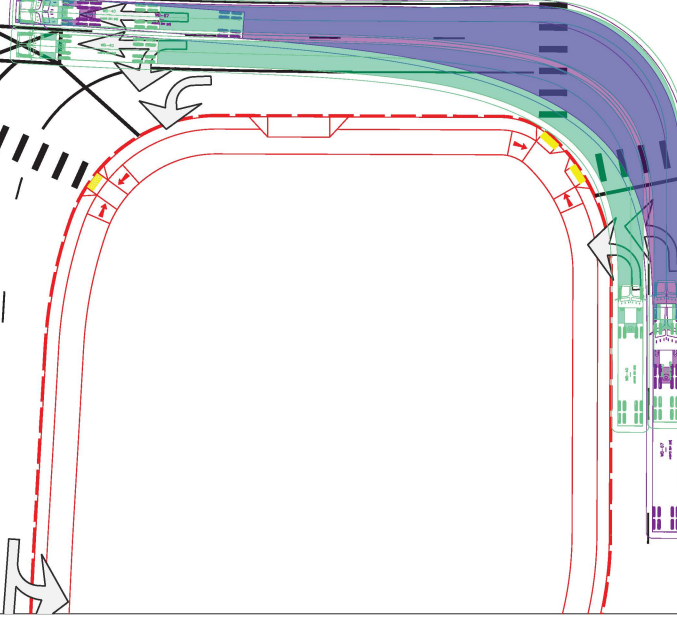
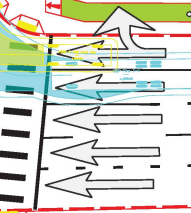
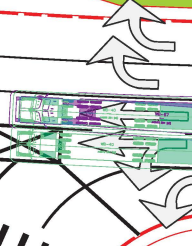
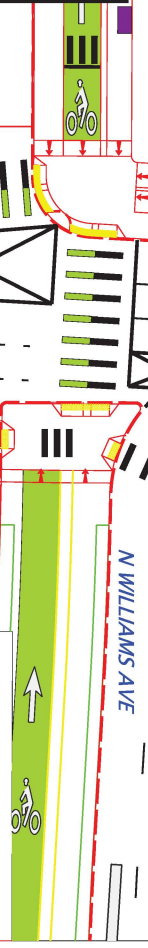
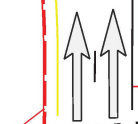

I-5: ROSE QUARTER
IMPROVEMENT PROJECT

AUTO TURN EXHIBITS
(LOCAL STREETS)

INTERSECTION 4

20% DESIGN PACKAGE

Last updated: December 4, 2020

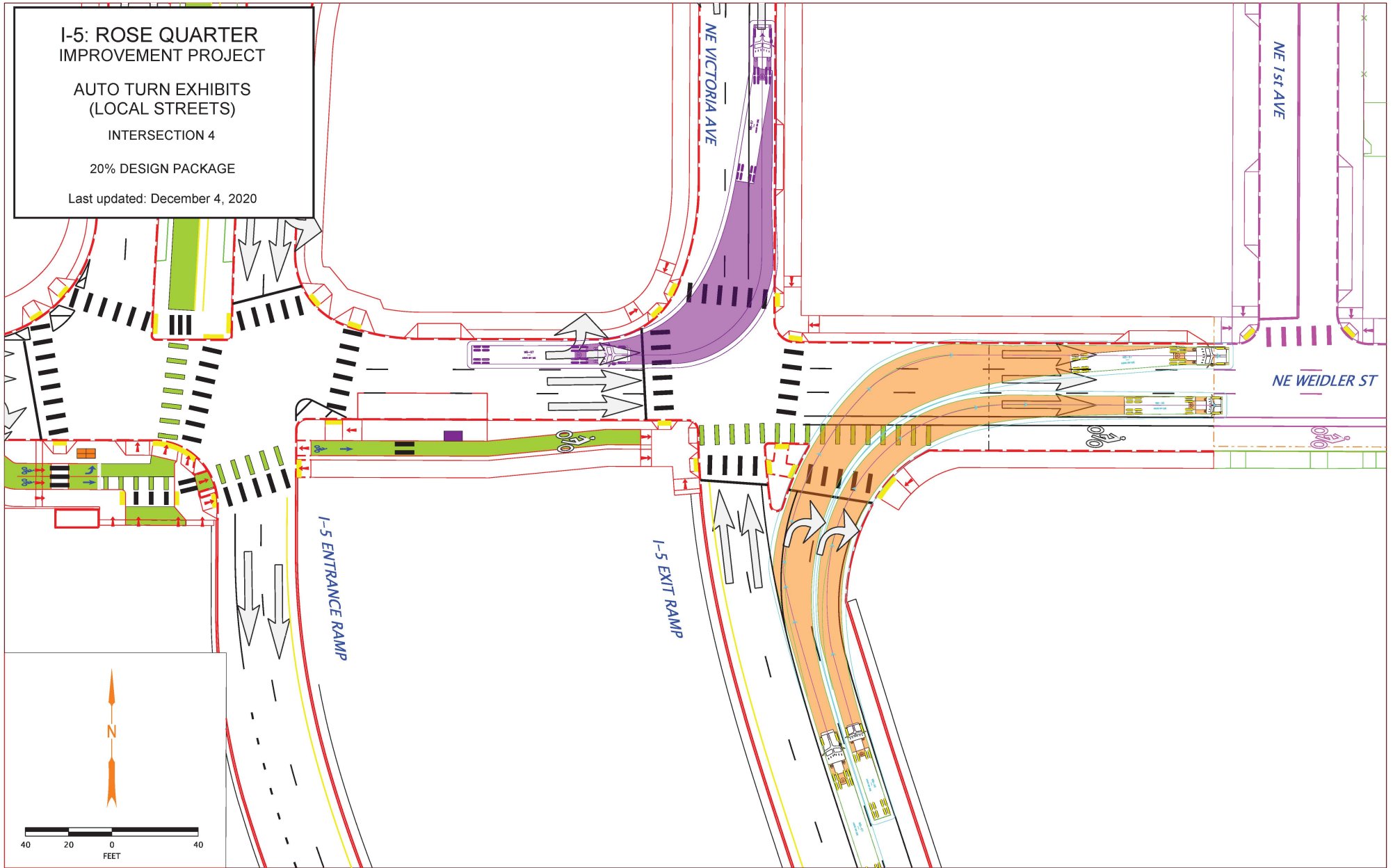

**I-5: ROSE QUARTER
IMPROVEMENT PROJECT**

**AUTO TURN EXHIBITS
(LOCAL STREETS)**

INTERSECTION 5 (1 OF 2)

20% DESIGN PACKAGE

Last updated: December 4, 2020

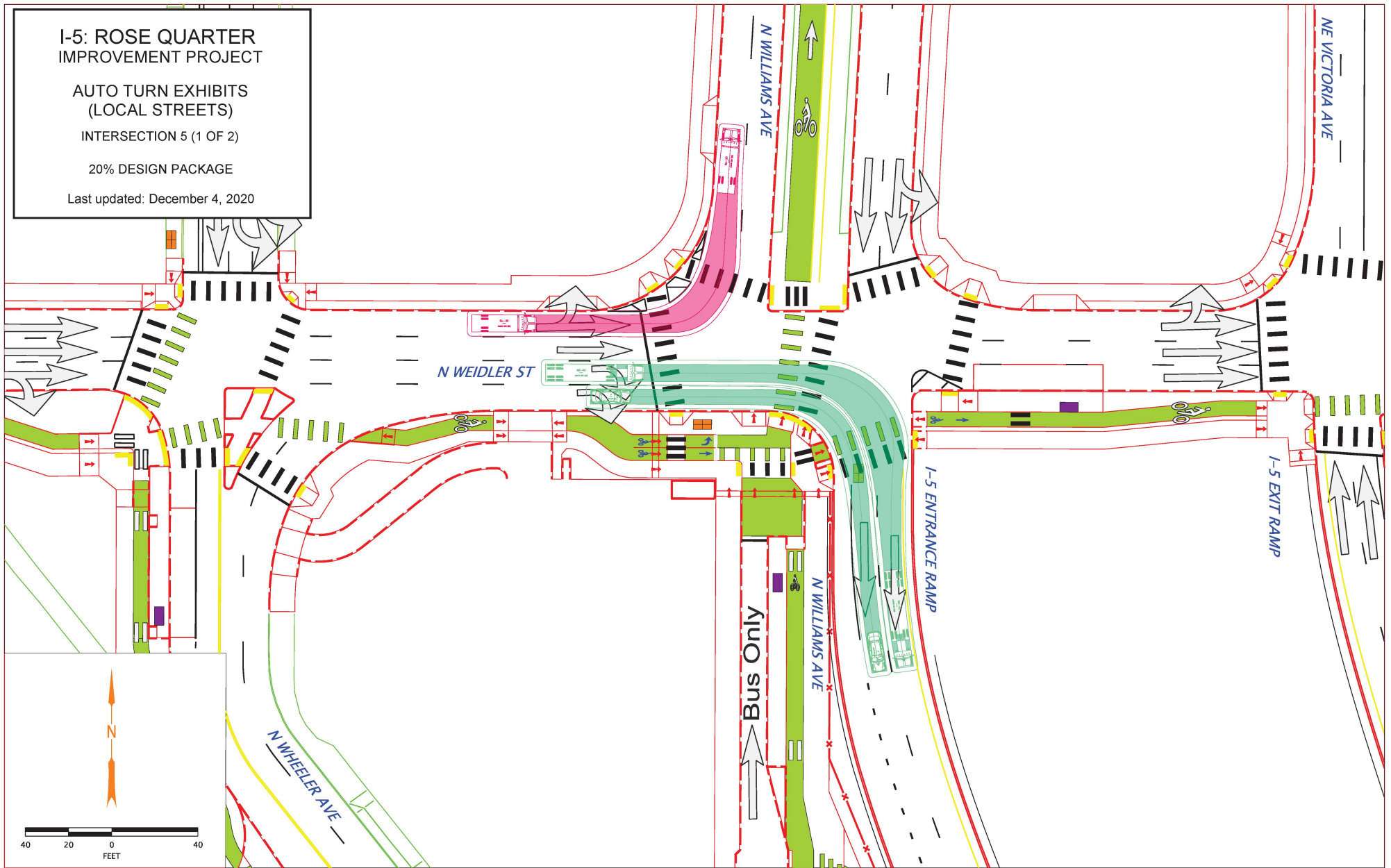

**I-5: ROSE QUARTER
IMPROVEMENT PROJECT**

**AUTO TURN EXHIBITS
(LOCAL STREETS)**

INTERSECTION 5 (2 OF 2)

20% DESIGN PACKAGE

Last updated: December 4, 2020

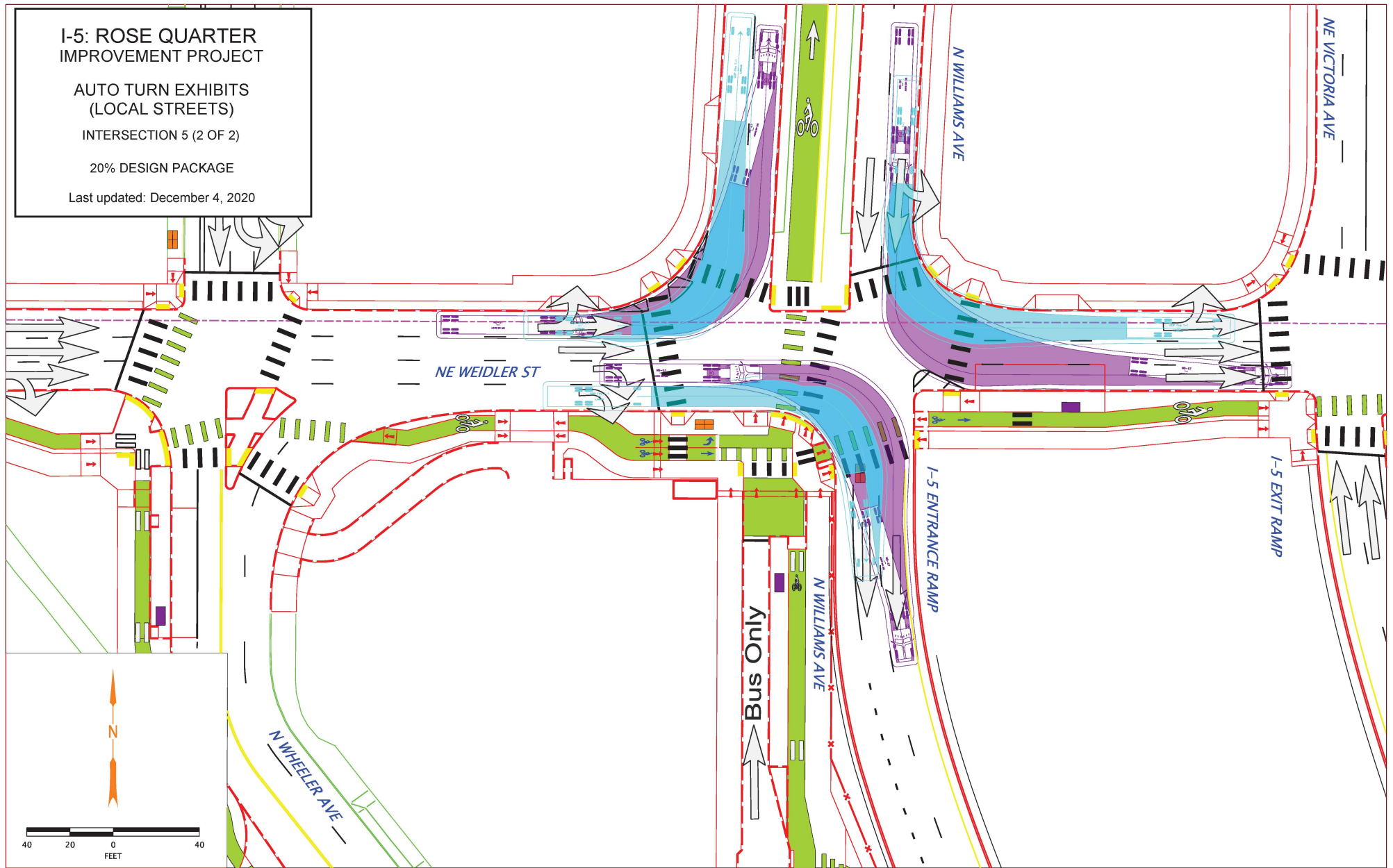

**I-5: ROSE QUARTER
IMPROVEMENT PROJECT**

**AUTO TURN EXHIBITS
(LOCAL STREETS)**

INTERSECTION 6 (1 of 2)

20% DESIGN PACKAGE

Last updated: December 4, 2020

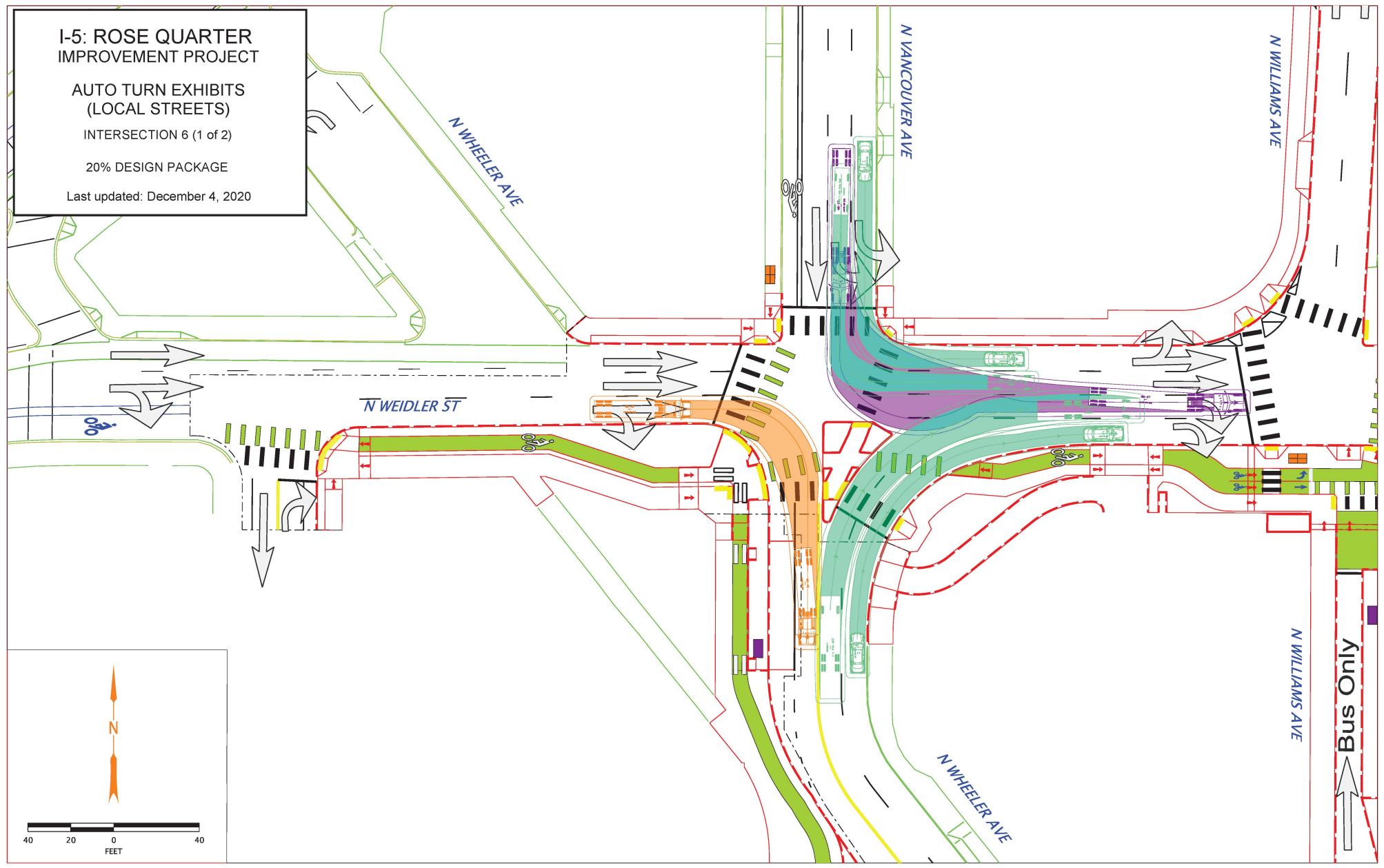

**I-5: ROSE QUARTER
IMPROVEMENT PROJECT**

**AUTO TURN EXHIBITS
(LOCAL STREETS)**

INTERSECTION 6 (2 of 2)

20% DESIGN PACKAGE

Last updated: December 4, 2020

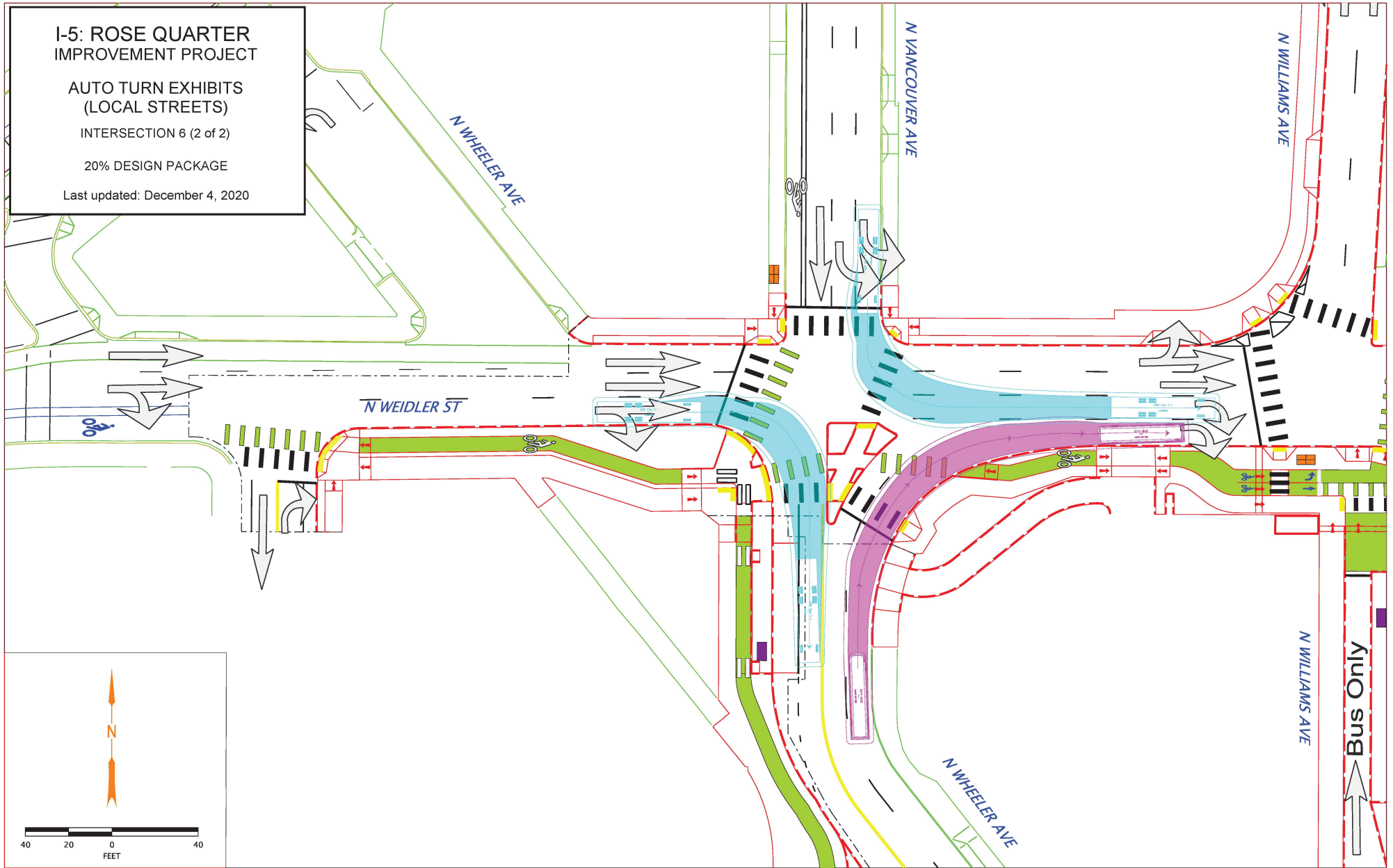

I-5: ROSE QUARTER
IMPROVEMENT PROJECT

AUTO TURN EXHIBITS
(LOCAL STREETS)

INTERSECTION 7

20% DESIGN PACKAGE

Last updated: December 4, 2020

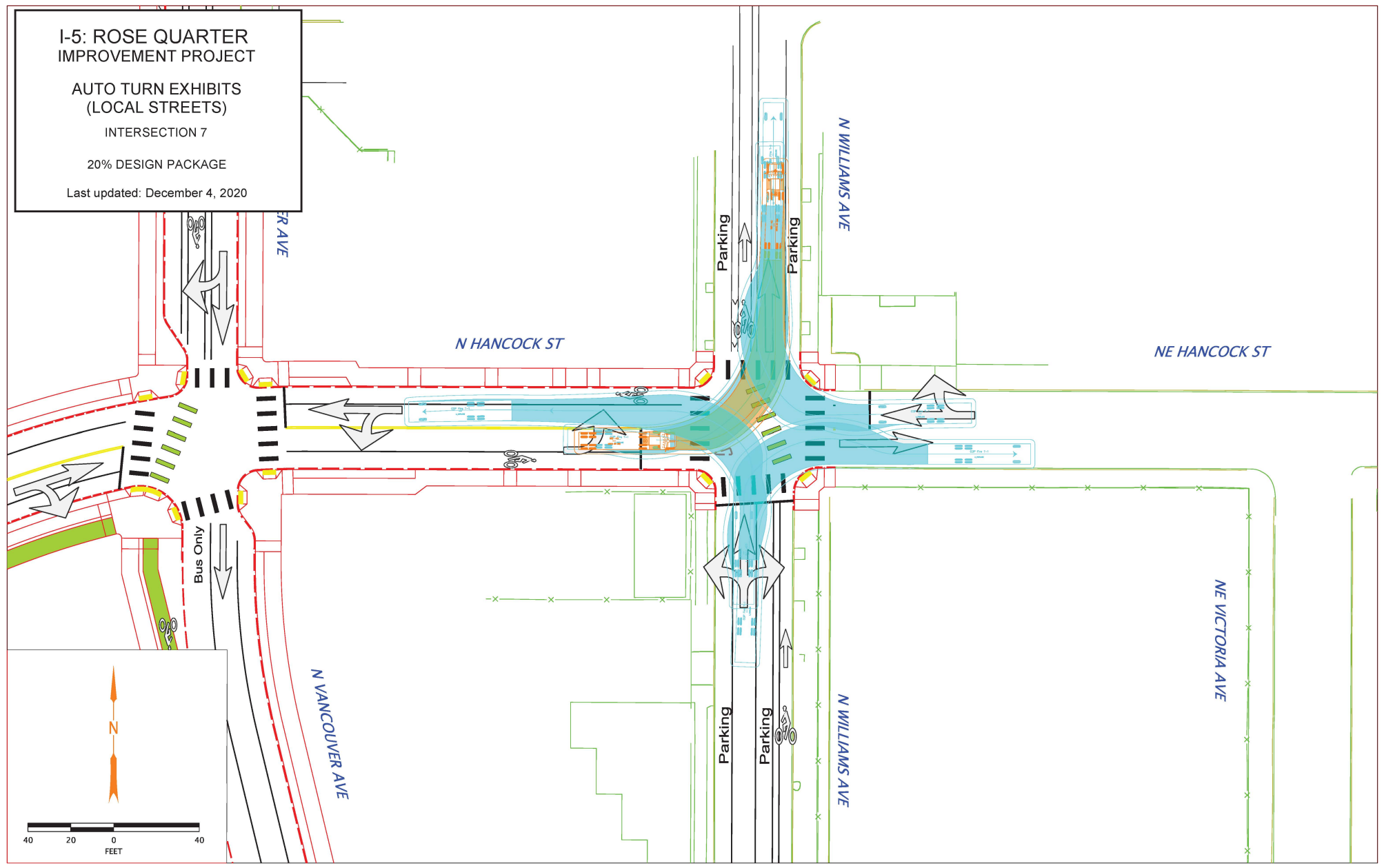

I-5: ROSE QUARTER
IMPROVEMENT PROJECT

AUTO TURN EXHIBITS
(LOCAL STREETS)

INTERSECTION 8

20% DESIGN PACKAGE

Last updated: December 4, 2020

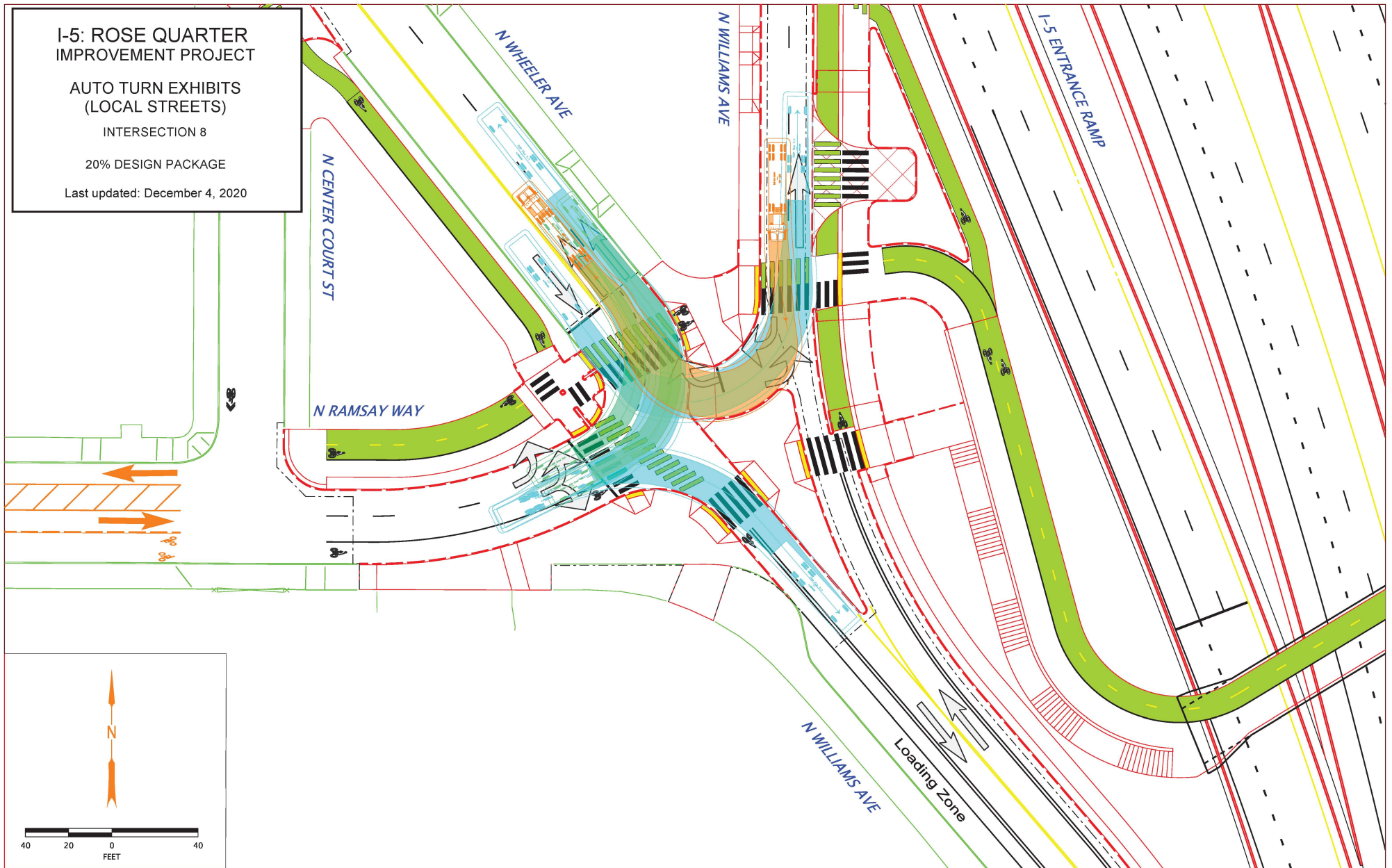

This page is intentionally left blank.